

Push-in fittings. manufactured entirely in nickel-plated brass.

All parts with a parallel thread are supplied with an FPM O-ring while the conical threads are coated with preCOTE 5 dispersion; all fittings in this series can thus also be used at high temperatures (medium compressed air).

Working pressure:	-0.98 bar to 16 bar
Operating temperature:	-20 °C to 150 °C
Material:	Nickel-plated brass
Sleeve:	Nickel-plated brass
Clamping ring:	stainless steel
O-ring:	FPM
Recommended hose:	PA and PU

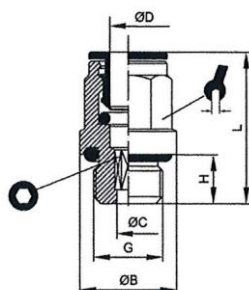

845.014-6

**Male connector**, parallel male thread with O-ring and outer hex (M-thread without outer hex)

Type No.	Art. No.	Ø D mm	Thread	Ø B mm	Ø C mm	H mm	L mm	mm	mm
845.005-4	108854	4	M5	9.0	2.6	4.0	20.5	Ø9	2.5
845.005-6	108855	6	M5	10.5	2.6	4.0	22.5	Ø10.5	2.5
845.018-4	108856	4	G 1/8	13.5	2.6	6.0	20.0	9	2.5
845.018-6	108857	6	G 1/8	13.5	4.2	6.0	24.0	11	4
845.018-8	108858	8	G 1/8	12.8	5.2	6.0	26.5	13	5
845.018-10	108859	10	G 1/8	13.5	5.2	6.0	29.0	16	5
845.014-4	108860	4	G 1/4	17.0	2.6	8.0	21.0	9	2.5
845.014-6	108861	6	G 1/4	17.0	4.2	8.0	24.0	11	4
845.014-8	108862	8	G 1/4	17.0	6.2	8.0	25.0	13	6
845.014-10	108863	10	G 1/4	16.0	7.3	8.0	29.0	16	7
845.014-12	108864	12	G 1/4	16.0	7.3	6.5	30.0	18	7
845.038-8	108865	8	G 3/8	20.0	6.2	9.0	25.0	13	6
845.038-10	108866	10	G 3/8	21.0	8.3	9.0	29.5	16	8
845.038-12	108867	12	G 3/8	21.0	10.3	9.0	31.0	18	10
845.038-14	108868	14	G 3/8	21.0	10.3	9.0	34.0	21	10
845.038-16	136773	16	G 3/8	21.0	10.3	9.0	36.0	24	10
845.012-10	108869	10	G 1/2	24.0	8.3	11.0	31.0	16	8
845.012-12	108870	12	G 1/2	24.0	10.3	11.0	31.5	18	10
845.012-14	108871	14	G 1/2	25.0	12.3	11.0	34.5	21	12
845.012-16	136774	16	G 1/2	24.0	12.3	11.0	37.5	24	12

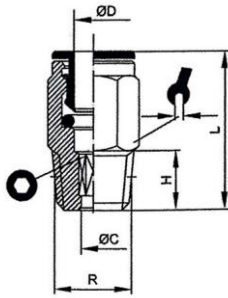

844.018-6

Male connector, conical male thread, coated with outer hex

Type No.	Art. No.	Ø D mm	Thread	Ø C mm	H mm	L mm	mm	mm
844.018-4	108882	4	R 1/8	2.6	7.0	22.5	10	2.5
844.018-6	108883	6	R 1/8	4.2	7.0	24.5	11	4
844.018-8	108884	8	R 1/8	5.2	7.0	27.5	13	5
844.014-4	108885	4	R 1/4	2.6	11.0	22.5	14	2.5
844.014-6	108886	6	R 1/4	4.2	11.0	24.5	14	4
844.014-8	108887	8	R 1/4	5.2	11.0	27.5	13	5
844.014-10	108888	10	R 1/4	7.3	11.0	32.5	16	7
844.014-12	108889	12	R 1/4	7.3	11.0	32.5	17	7
844.038-8	108890	8	R 3/8	5.2	11.5	28.0	17	5
844.038-10	108891	10	R 3/8	8.3	11.5	32.5	17	8
844.038-12	108892	12	R 3/8	8.3	11.5	30.5	17	8
844.012-12	108893	12	R 1/2	10.3	14.0	33.0	22	10

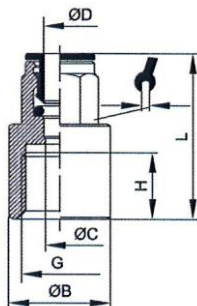

846.014-6

Male connector, parallel female thread with outer hex

Type No.	Art. No.	Ø D mm	Thread	Ø B mm	Ø C mm	H mm	L mm	mm
846.018-4	108872	4	G 1/8	12.0	3.0	6.5	26.5	9
846.018-6	108873	6	G 1/8	12.0	5.0	6.5	27.0	11
846.018-8	108874	8	G 1/8	12.0	7.0	6.5	28.0	13
846.014-4	108875	4	G 1/4	17.0	3.0	10.0	29.5	9
846.014-6	108876	6	G 1/4	17.0	5.0	10.0	31.0	11
846.014-8	108877	8	G 1/4	17.0	7.0	10.0	32.0	13
846.014-10	108878	10	G 1/4	16.0	9.0	10.0	32.0	16
846.014-12	108879	12	G 1/4	20.0	11.0	15.0	40.0	20
846.038-10	108880	10	G 3/8	20.0	9.0	13.0	37.5	20
846.038-12	108881	12	G 3/8	20.0	11.0	15.0	39.5	20
846.012-16	136775	16	G 1/2	24.0	14.5	15.0	41.0	24

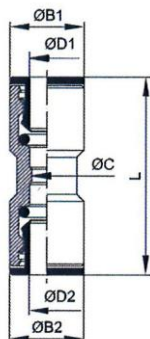

847.006

### Union

Type No.	Art. No.	Ø D1 mm	Ø D2 mm	Ø B1 mm	Ø B2 mm	Ø C mm	L mm
847.004	108966	4	4	9.0	9.0	3.0	31.0
847.006	108967	6	6	11.0	11.0	5.0	33.0
847.008	108968	8	8	13.0	13.0	7.0	37.0
847.010	108969	10	10	15.0	15.0	9.0	39.0
847.012	108970	12	12	17.0	17.0	11.0	43.0
847.014	108971	14	14	20.0	20.0	12.0	48.0
847.016	136779	16	16	24.0	24.0	14.0	50.0

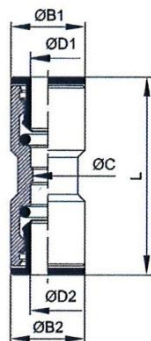

847.1008

### Reducer

Type No.	Art. No.	Ø D1 mm	Ø D2 mm	Ø B1 mm	Ø B2 mm	Ø C mm	L mm
847.0604	108972	6	4	11.0	9.0	3.0	33.0
847.0806	108973	8	6	13.0	11.0	5.0	39.0
847.1008	108974	10	8	16.0	13.0	7.0	39.0
847.1210	108975	12	10	20.0	15.0	9.0	42.5

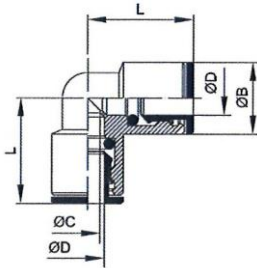

848.006

**Union elbow**

Type No.	Art. No.	Ø D mm	Ø B mm	Ø C mm	L mm
848.004	108982	4	9.0	3.0	17.5
848.006	108983	6	11.0	5.0	20.0
848.008	108984	8	13.0	7.0	23.0
848.010	108985	10	15.0	8.0	25.0
848.012	108986	12	17.0	10.0	27.5
848.014	108987	14	20.0	12.0	31.0
848.016	136781	16	23.0	14,0	33.0

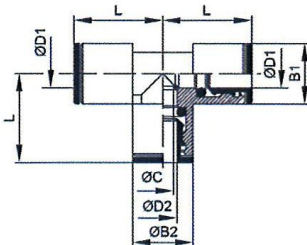

849.006

**Union tee**

Type No.	Art. No.	Ø D1 mm	Ø D2 mm	Ø B1 mm	Ø B2 mm	Ø C mm	L1 mm	L2 mm
849.004	108988	4	4	9.0	9.0	3.0	34.0	17.0
849.006	108989	6	6	11.0	11.0	5.0	39.0	19.5
849.008	108990	8	8	13.0	13.0	7.0	46.0	23.0
849.010	108991	10	10	15.0	15.0	8.0	50.0	25.0
849.012	108992	12	12	17.0	17.0	10.0	54.0	27.0
849.014	108993	14	14	20.0	20.0	12.0	62.0	31.0
849.016	136782	16	16	23.0	23.0	14.5	72.0	36.0

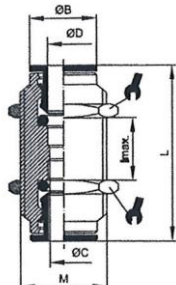

851.016-8

### Female bulkhead connector

Type No.	Art. No.	Ø D mm	Ø C mm	Thread	Ø B mm	l <sub>max</sub>	L mm	 mm
851.010-4	108976	4	3.0	M10x1.0	8.0	15.0	31.5	13
851.014-6	108977	6	5.0	M14x1.0	11.0	11.0	33.5	17
851.016-8	108978	8	7.0	M16x1.0	13.0	16.0	37.0	18
851.017-10	108979	10	9.0	M17x1.0	15.0	19.0	39.5	20
851.020-12	108980	12	11.0	M20x1.0	17.0	17.0	42.0	24
851.022-14	108981	14	13.0	M22x1.0	20.0	21.0	46.0	25
851.028-16	136780	16	14.5	M28x1.5	24.0	22.0	50.0	36

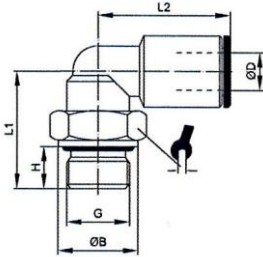

854.014-6

Male elbow, swivel type, parallel male thread with O-ring

Type No.	Art. No.	Ø D mm	Thread	Ø B mm	H mm	L1 mm	L2 mm	 mm
854.005-4	108894	4	M5	8.0	4.0	14.5	18.0	9
854.005-6	108895	6	M5	8.0	4.0	14.5	21.0	9
854.018-4	108896	4	G 1/8	13.0	6.0	20.0	20.0	13
854.018-6	108897	6	G 1/8	13.0	6.0	20.0	21.0	13
854.018-8	108898	8	G 1/8	13.0	6.0	20.0	24.0	13
854.018-10	136776	10	G 1/8	13.0	5.5	23.5	26.5	13
854.014-4	108899	4	G 1/4	16.0	8.0	24.0	20.0	13
854.014-6	108900	6	G 1/4	16.0	8.0	24.0	21.0	13
854.014-8	108901	8	G 1/4	16.0	8.0	24.0	24.0	13
854.014-10	108902	10	G 1/4	16.0	8.0	24.0	27.0	16
854.014-12	108903	12	G 1/4	16.0	6.5	29.0	30.5	16
854.038-8	108904	8	G 3/8	20.0	9.0	25.5	24.0	13
854.038-10	108905	10	G 3/8	20.0	9.0	28.0	27.0	16
854.038-12	108906	12	G 3/8	20.0	9.0	29.0	29.0	20
854.038-14	137008	14	G 3/8	19.8	9.0	28.5	32.0	20
854.038-16	136777	16	G 3/8	19.8	9.0	33.0	33.5	20
854.012-10	108907	10	G 1/2	25.0	11.0	30.0	27.0	16
854.012-12	108908	12	G 1/2	25.0	11.0	35.0	29.0	20
854.012-14	137009	14	G 1/2	25.0	11.0	35.0	32.0	20
854.012-16	136778	16	G 1/2	25.0	11.0	38.0	33.5	20

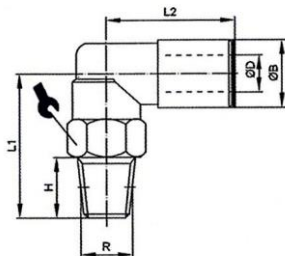

8854.014-6

**Male elbow, swivel type, conical male thread, coated**

Type No.	Art. No.	Ø D mm	Thread	H mm	L1 mm	L2 mm	 mm
8854.018-4	108909	4	R 1/8	7.0	20.0	20.0	13
8854.018-6	108910	6	R 1/8	7.0	20.0	21.0	13
8854.018-8	108911	8	R 1/8	7.0	20.0	24.0	13
8854.014-4	108912	4	R 1/4	11.0	25.0	20.0	14
8854.014-6	108913	6	R 1/4	11.0	25.0	21.0	14
8854.014-8	108914	8	R 1/4	11.0	25.0	24.0	14
8854.014-10	108915	10	R 1/4	11.0	26.0	27.0	16
8854.038-8	108916	8	R 3/8	11.0	28.0	24.0	18
8854.038-10	108917	10	R 3/8	11.0	30.0	27.0	18
8854.038-12	108918	12	R 3/8	11.0	32.5	28.5	20
8854.038-14	137010	14	R 3/8	14.0	35.5	32.0	22
8854.012-12	108919	12	R 1/2	14.0	35.5	28.5	22
8854.012-14	137011	14	R 1/2	14.0	35.5	32.0	22

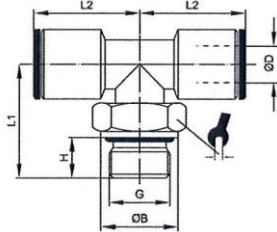

855.014-6

Male branch tee, swivel type, parallel male thread with O-ring

Type No.	Art. No.	Ø D mm	Thread	Ø B mm	H mm	L1 mm	L2 mm	 mm
855.018-4	108920	4	G 1/8	13.0	6.0	20.0	20.0	13
855.018-6	108921	6	G 1/8	13.0	6.0	20.0	21.5	13
855.018-8	108922	8	G 1/8	13.0	6.0	20.0	23.5	13
855.014-6	108923	6	G 1/4	16.0	8.0	24.0	21.5	13
855.014-8	108924	8	G 1/4	16.0	8.0	24.0	23.5	13
855.014-10	108925	10	G 1/4	16.0	8.0	24.0	26.5	16
855.038-8	108926	8	G 3/8	20.0	9.0	25.5	23.5	13
855.038-10	108927	10	G 3/8	20.0	9.0	28.0	26.5	16
855.038-12	108928	12	G 3/8	19.8	9.0	34.5	29.0	20
855.038-14	137012	14	G 3/8	19.8	9.0	28.5	32.0	20
855.012-12	108929	12	G 1/2	25.0	11.0	34.5	29.0	20
855.012-14	137013	14	G 1/2	25.0	11.0	33.5	32.0	20



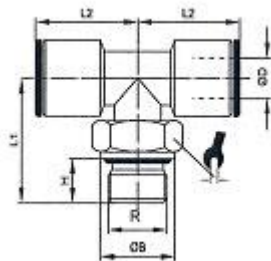

8855.014-6

**Male branch tee, swivel type, conical male thread, coated**

Type No.	Art. No.	Ø D mm	Thread	Ø B mm	H mm	L1 mm	L2 mm	 mm
8855.018-4	108930	4	R 1/8	12.8	7.0	20.0	20.0	13
8855.018-6	108931	6	R 1/8	12.8	7.0	20.0	21.5	13
8855.018-8	108932	8	R 1/8	12.8	7.0	20.0	23.5	13
8855.014-6	108933	6	R 1/4	14.0	11.0	25.0	21.5	14
8855.014-8	108934	8	R 1/4	14.0	11.0	25.0	23.5	14
8855.014-10	108935	10	R 1/4	16.0	11.0	26.0	26.5	16
8855.038-8	108936	8	R 3/8	18.0	11.0	28.0	23.5	18
8855.038-10	108937	10	R 3/8	18.0	11.0	53.0	30.0	18
8855.038-12	108938	12	R 3/8	20.0	11.0	58.0	32.5	20
8855.038-14	137014	14	R 3/8	-	11.0	32.5	32.0	22
8855.012-12	108939	12	R 1/2	22.0	14.0	58.0	35.5	22
8855.012-14	137015	14	R 1/2	-	14.0	35.5	32.0	22

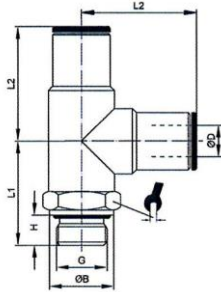

862.014-6

**Male branch tee, angled plug connections, swivel type, parallel male thread with O-ring**

Type No.	Art. No.	Ø D mm	Thread	Ø B mm	H mm	L1 mm	L2 mm	 mm
862.018-4	108940	4	G 1/8	13.0	6.0	18.0	17.5	13
862.018-6	108941	6	G 1/8	13.0	6.0	20.5	21.0	13
862.018-8	108942	8	G 1/8	13.0	6.0	20.0	23.0	13
862.014-6	108943	6	G 1/4	16.0	8.0	24.5	21.0	13
862.014-8	108944	8	G 1/4	16.0	8.0	24.5	23.0	13
862.014-10	108945	10	G 1/4	16.0	8.0	24.0	27.0	16
862.038-8	108946	8	G 3/8	20.0	9.0	25.7	23.4	13
862.038-10	108947	10	G 3/8	20.0	9.0	27.0	27.0	16
862.038-12	108948	12	G 3/8	20.0	9.0	28.0	29.0	16
862.038-14	137016	14	G 3/8	19.8	9.0	28.5	32.0	20
862.012-12	108949	12	G 1/2	25.0	11.0	30.0	28.5	16
862.012-14	137017	14	G 1/2	25.0	11.0	34.0	33.0	20

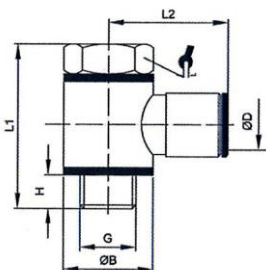

863.018-6

**Banjo elbow with outer hex, parallel male thread with O-ring**

Type No.	Art. No.	Ø D mm	Thread	Ø B mm	H mm	L1 mm	L2 mm	 mm
863.005-4	108950	4	M5	SW9	3.0	17.5	18.0	8
863.005-5	108951	5	M5	SW9	3.0	17.5	19.0	8
863.005-6	108952	6	M5	SW9	3.0	19.5	19.5	8
863.018-4	108953	4	G 1/8	14.0	5.5	28.0	20.5	14
863.018-6	108954	6	G 1/8	14.0	5.5	28.0	23.0	14
863.018-8	108955	8	G 1/8	14.0	5.5	28.0	24.5	14
863.014-6	108956	6	G 1/4	18.0	7.0	33.0	24.0	17
863.014-8	108957	8	G 1/4	18.0	7.0	33.0	26.0	17
863.014-10	108958	10	G 1/4	18.0	7.0	33.0	27.0	17
863.038-8	108959	8	G 3/8	21.0	8.5	36.0	27.0	19
863.038-10	108960	10	G 3/8	22.0	7.5	28.0	36.5	19
863.038-12	108961	12	G 3/8	21.0	8.5	36.0	29.0	19
863.012-12	108962	12	G 1/2	27.0	10.0	34.5	42.0	24

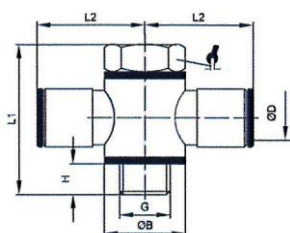

864.018-6

**Male branch tee with outer hex, swivel type, parallel male thread with O-ring**

Type No.	Art. No.	Ø D mm	Thread	Ø B mm	H mm	L1 mm	L2 mm	 mm
864.018-4	108963	4	G 1/8	14.0	5.5	28.0	21.0	14
864.018-6	108964	6	G 1/8	14.0	5.5	28.0	23.0	14
864.014-6	108965	6	G 1/4	18.0	7.0	33.0	24.0	17

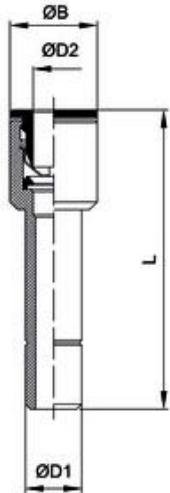

867.0806

**Reducer with push-in plug**

Only recommended for use in combination with quick connectors of the »metallica« series. Suitability testing for use with other series is the responsibility of the user.

Type No.	Art. No.	Ø D1 mm	Ø D2 mm	Ø B mm	L mm
867.0604	108994	6	4	9.0	29.5
867.0806	108995	8	6	11.0	33.0
867.1008	108996	10	8	13.0	38.5
867.1210	108997	12	10	15.0	41.0
867.1412	137018	14	12.2	17.0	44.0

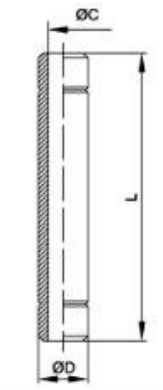

769.006

### Push-in plug

Only recommended for use in combination with quick connectors of the »metallica« series. Suitability testing for use with other series is the responsibility of the user.

Operating temperature:                    -20 °C to 80 °C

Type No.	Art. No.	Ø D mm	Ø C mm	L mm
8865.004	142787	4	2	35.0
8865.006	142788	6	4	36.5
8865.008	142789	8	6	40.0
8865.010	142790	10	8	45.5
8865.012	142793	12	10	48.0
8865.014	129491	14	12	53.0